

The WHO Global Network of Age-friendly Cities

John Beard

Director, Department of Ageing and Life
Course

Outline

- Background
- The WHO Global Network of Age-friendly Cities
- Future directions





Real ageing is just beginning

Source: World Population Prospects: 2008 Revision

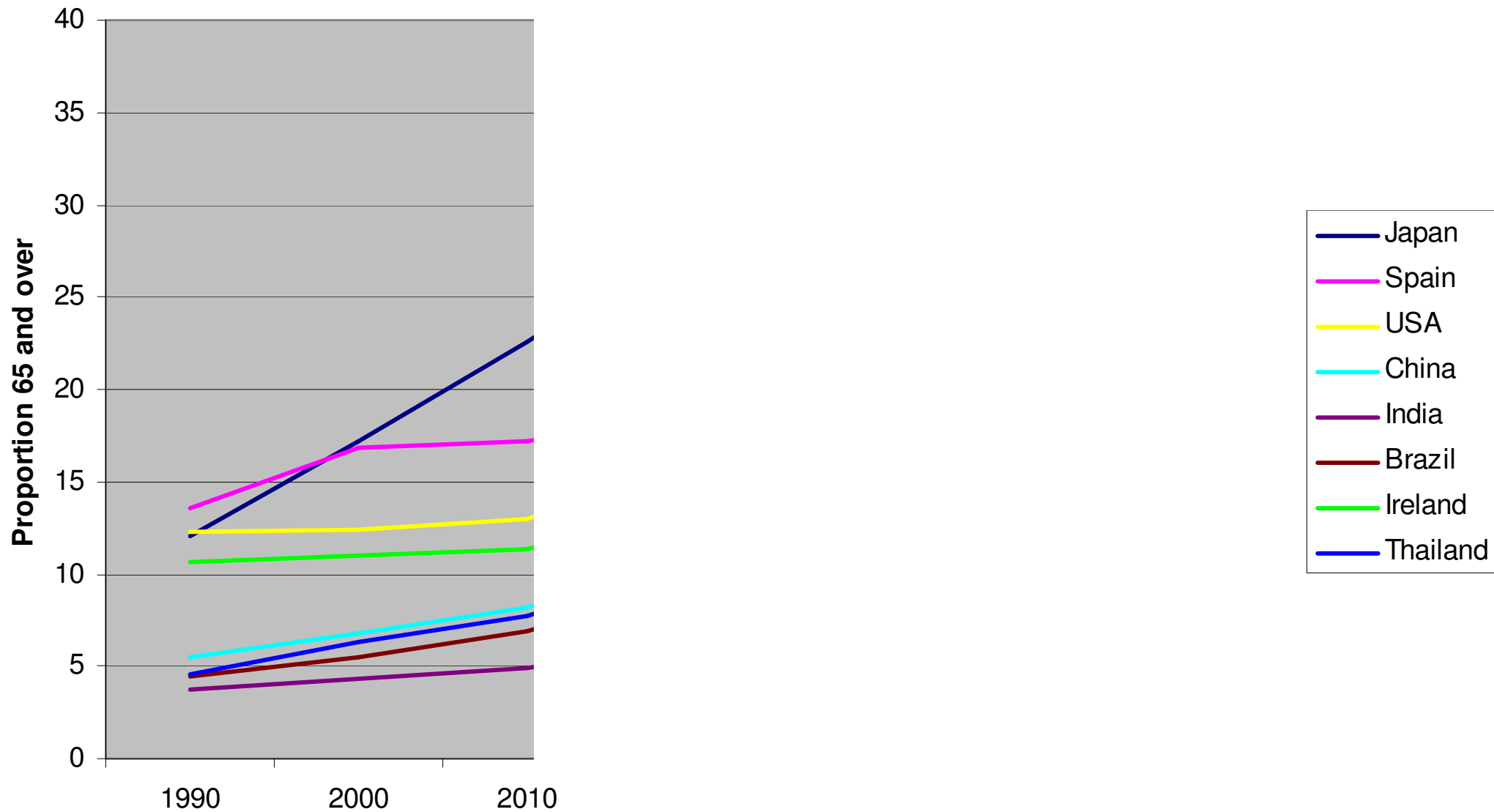

Real ageing is just beginning

Source: World Population Prospects: 2008 Revision

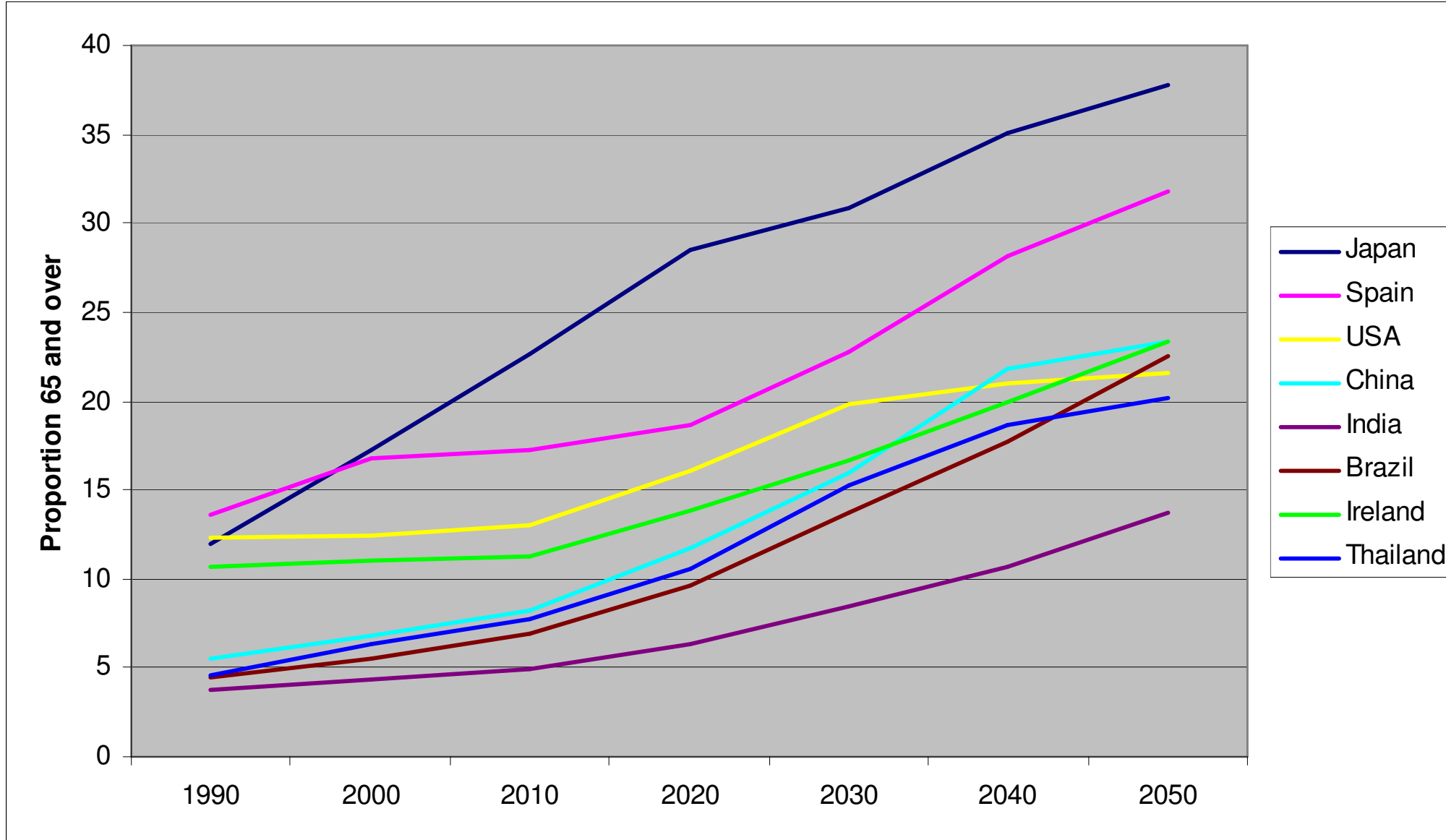

Seeing population ageing as a burden on society

Figure 2. Old-age dependency ratio (number of people aged 65 and over per 100 persons of working age)

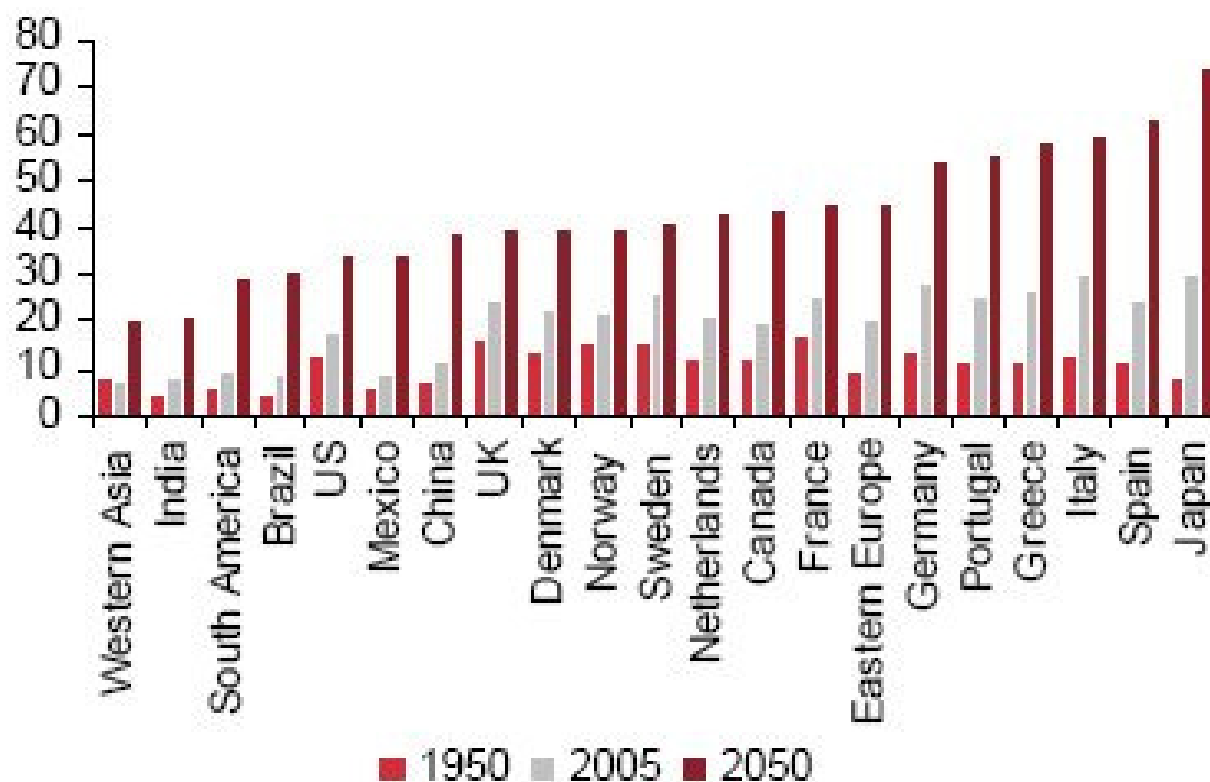

World Health
Organization

From burden to boon

- Health promotion across the life course – the importance of HEALTH
- Creating environments that foster engagement
- Access to age-friendly primary health care
 - Integrated
 - Screening, early detection and amelioration of chronic disease
 - Access to medications
 - Skilled and supported workforce
 - LONG TERM CARE (home and institutional)
- Rethinking ageing

Life Course Approach to Ageing

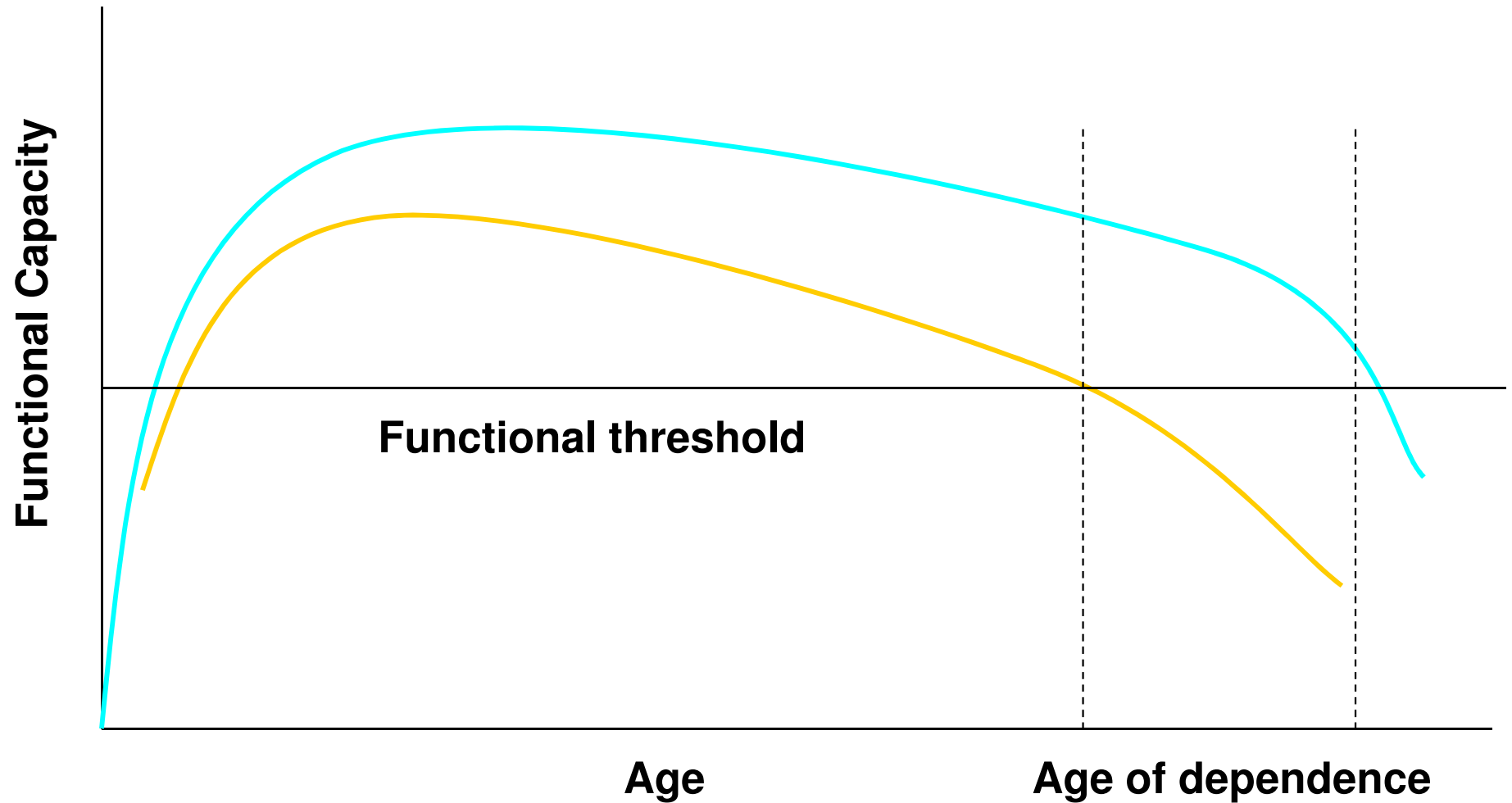

Life Course Approach to Ageing

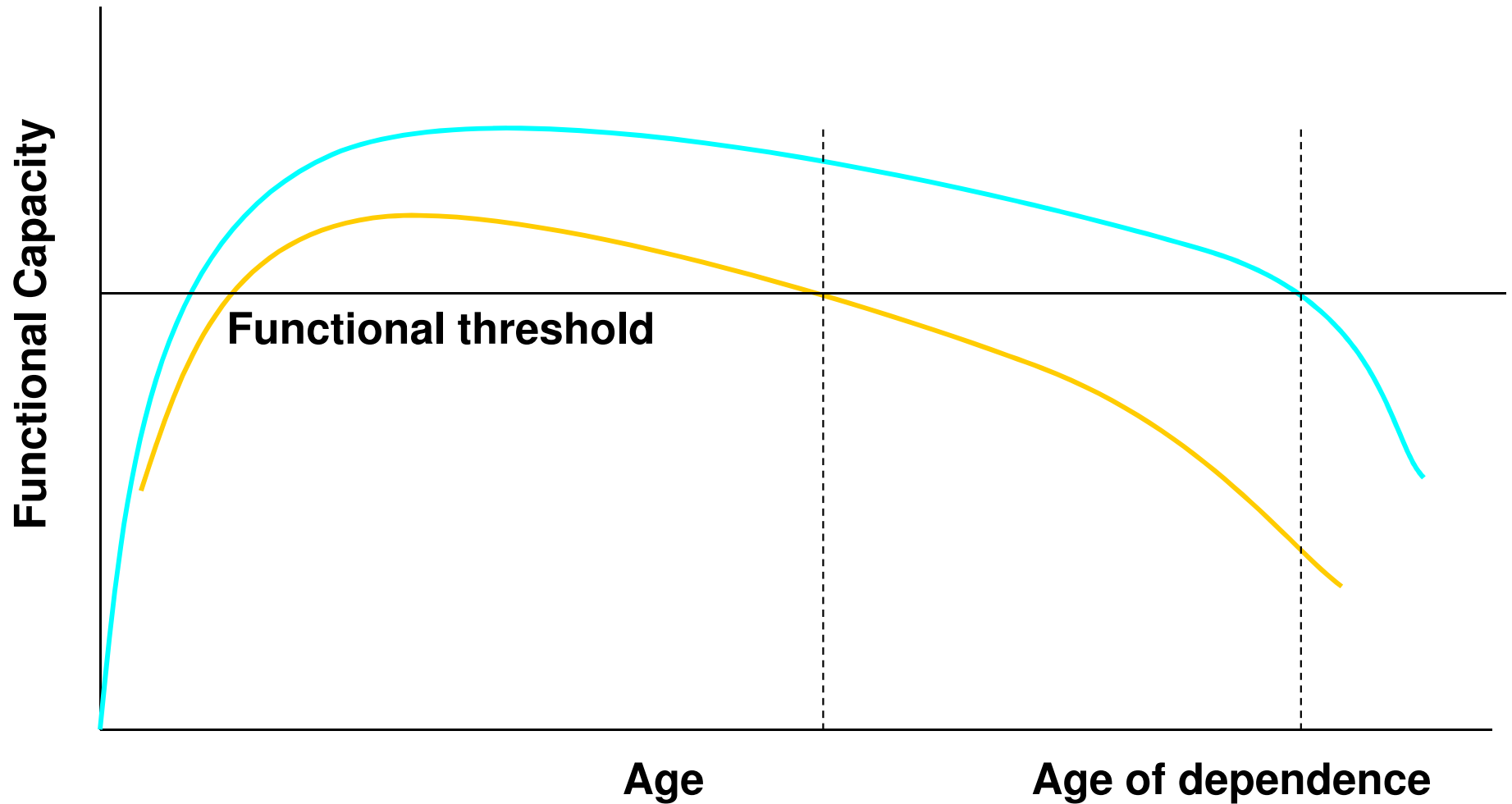

Life Course Approach to Ageing

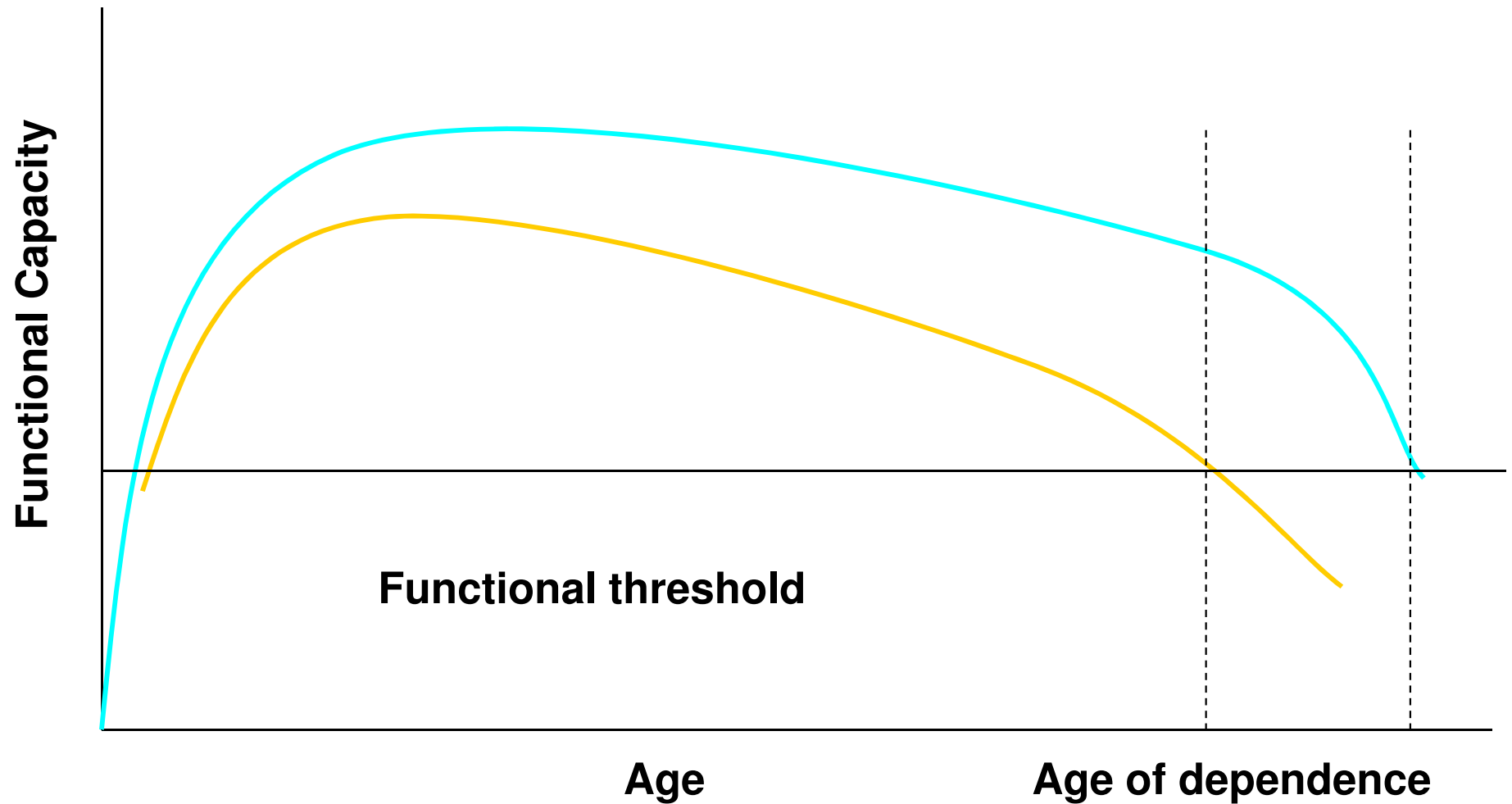

Age-Friendly Cities

*Urban environments
that promote active
ageing*



Key Themes of an Age-friendly City



Outdoor space & buildings



Transportation



Communication & information



Housing



Respect & social inclusion



Social participation



Civic participation & employment



Community support & health services

WHO Global Network of Age-friendly Cities

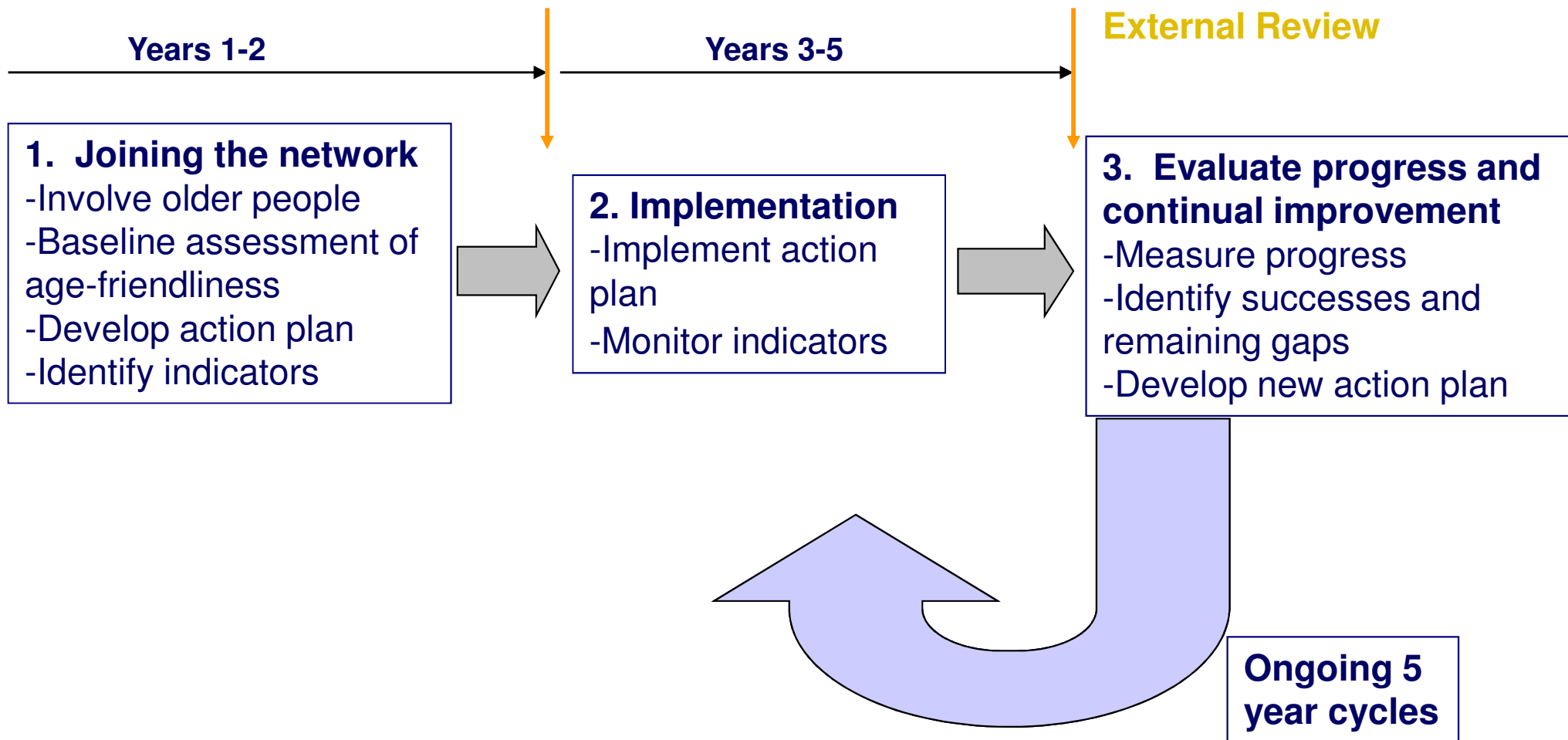

WHO Global Network of Age-friendly Cities



Launch of the Global Network

June 28 2010



New York – a City for All Ages

<http://www.agefriendlynyc.org>

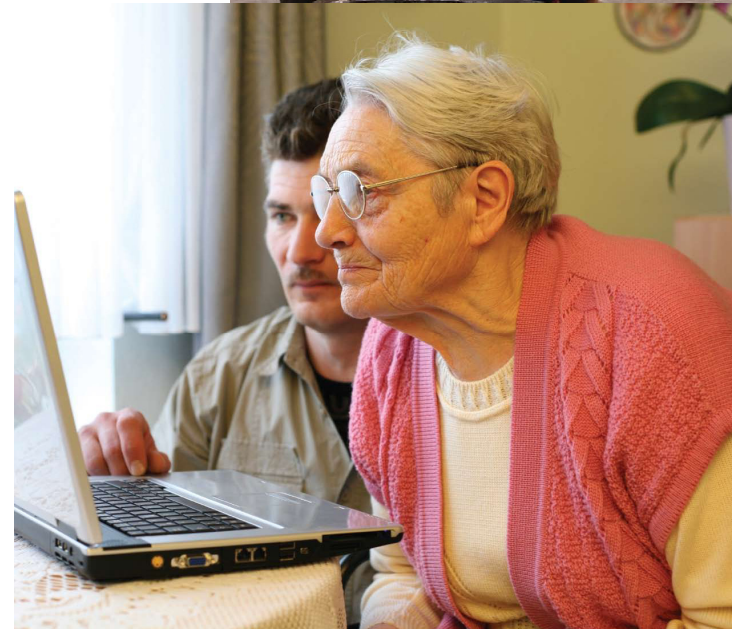
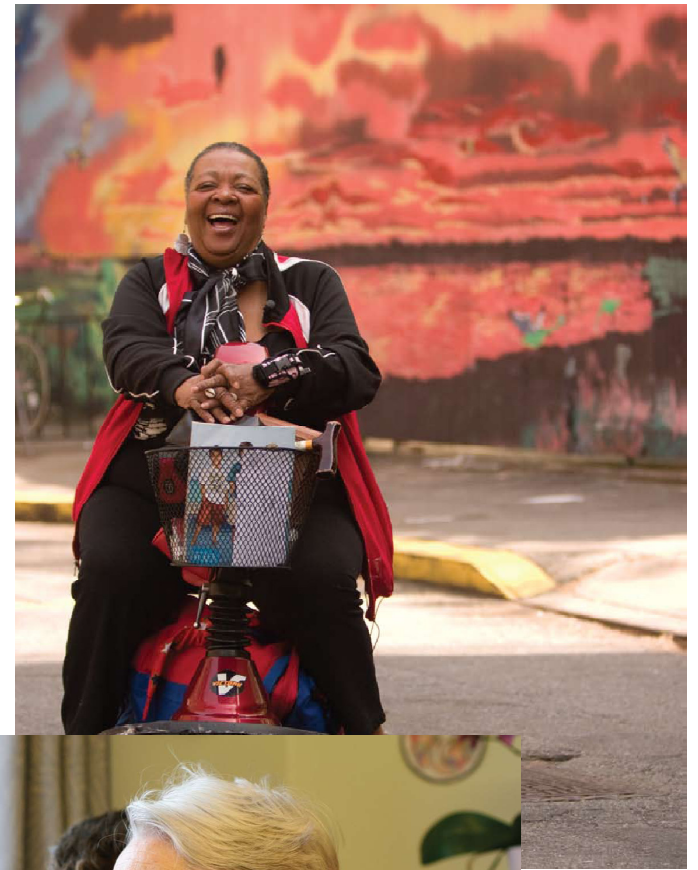

Early Action Improvements Implemented July 2008

Seniors given more time to cross the major street at 26 of the 43 intersections

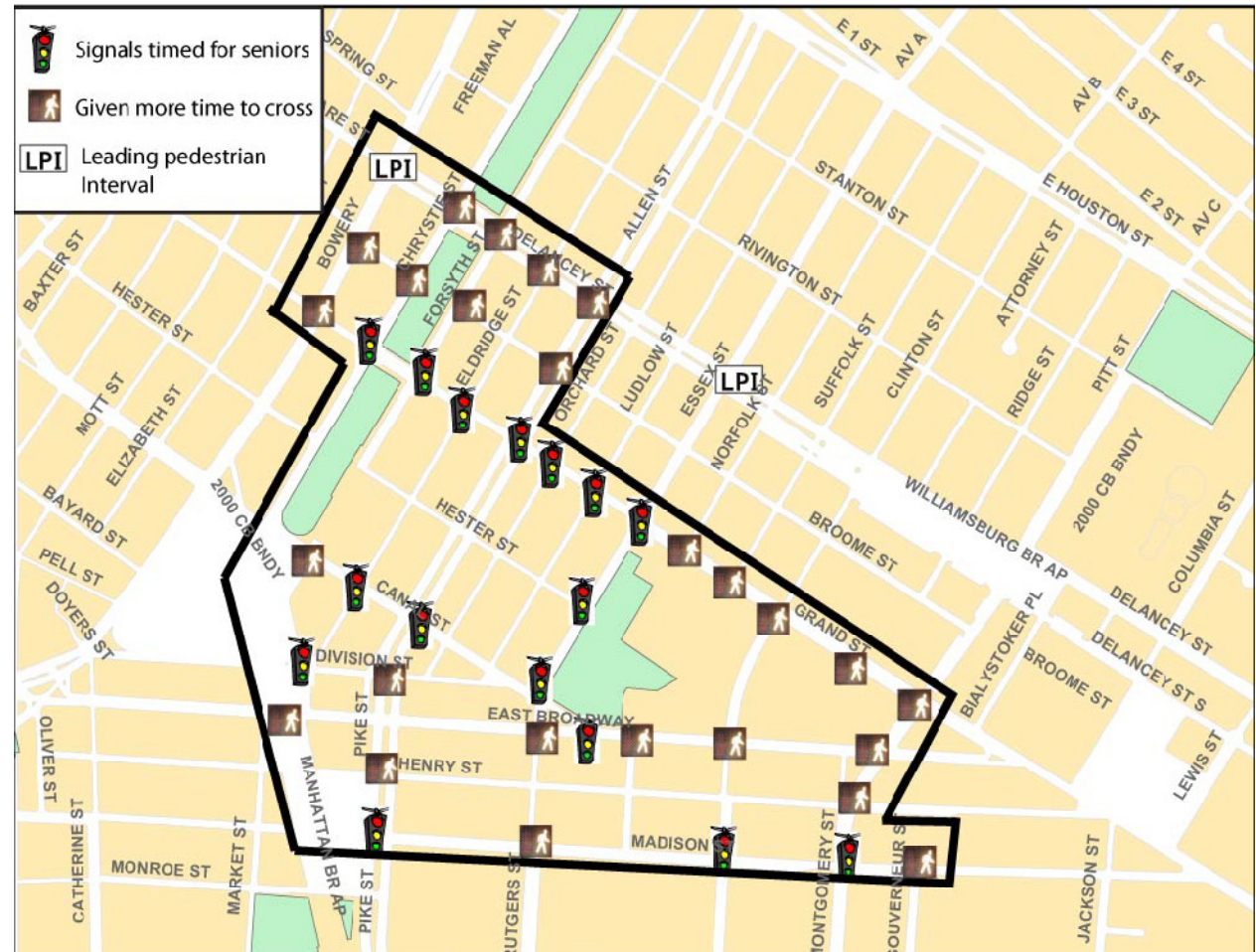

Streetscape 1

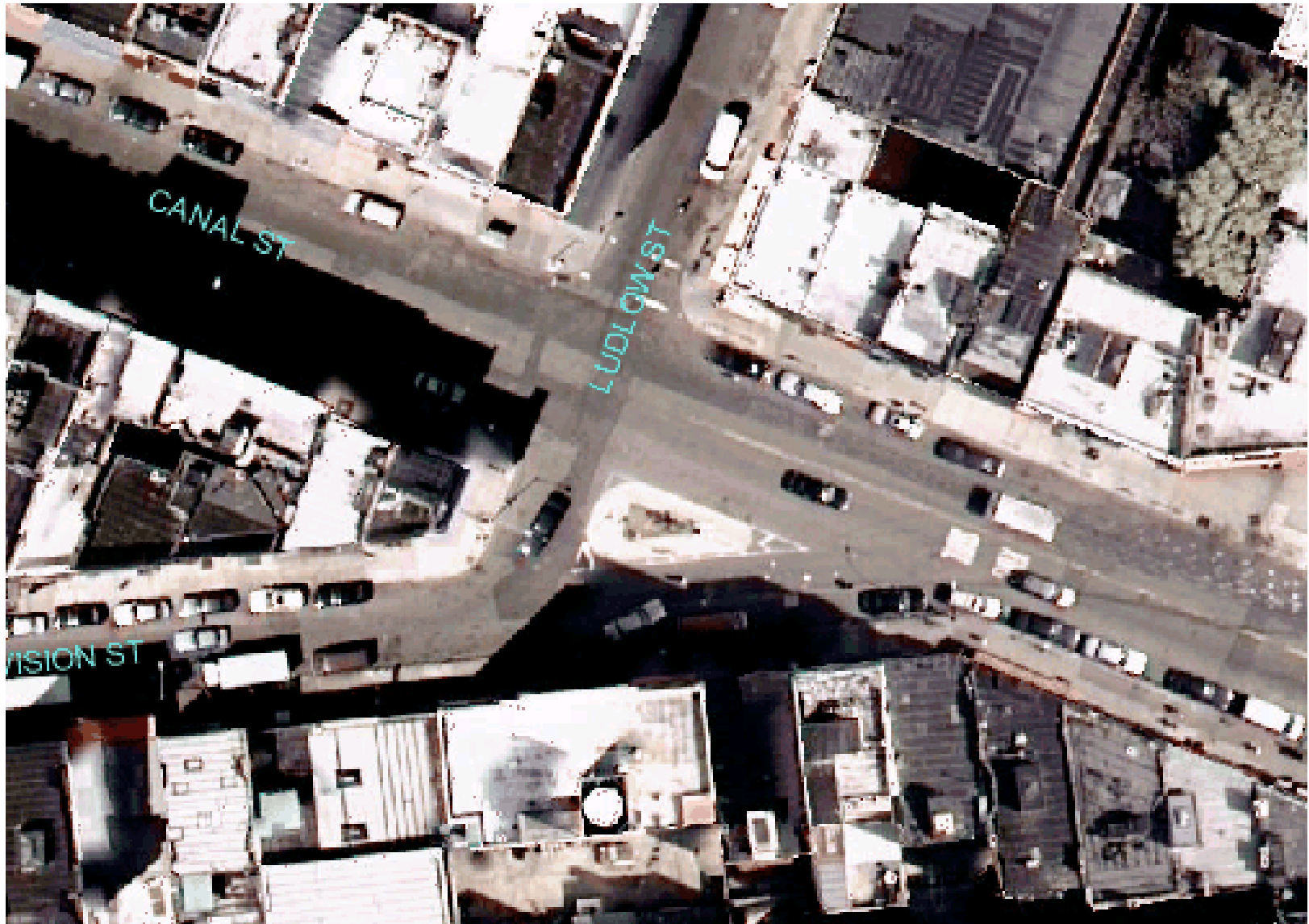

Streetscape 1

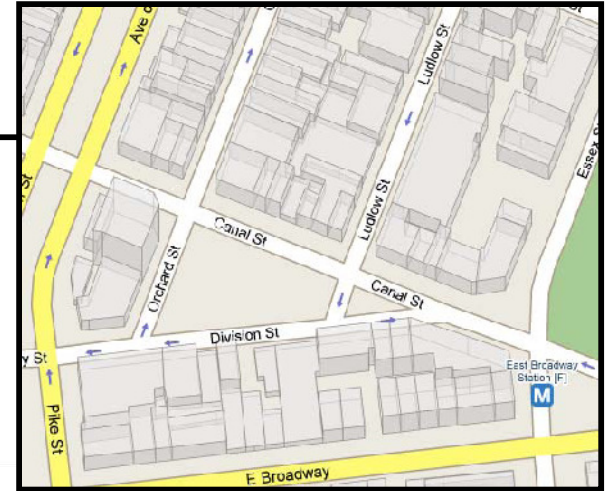
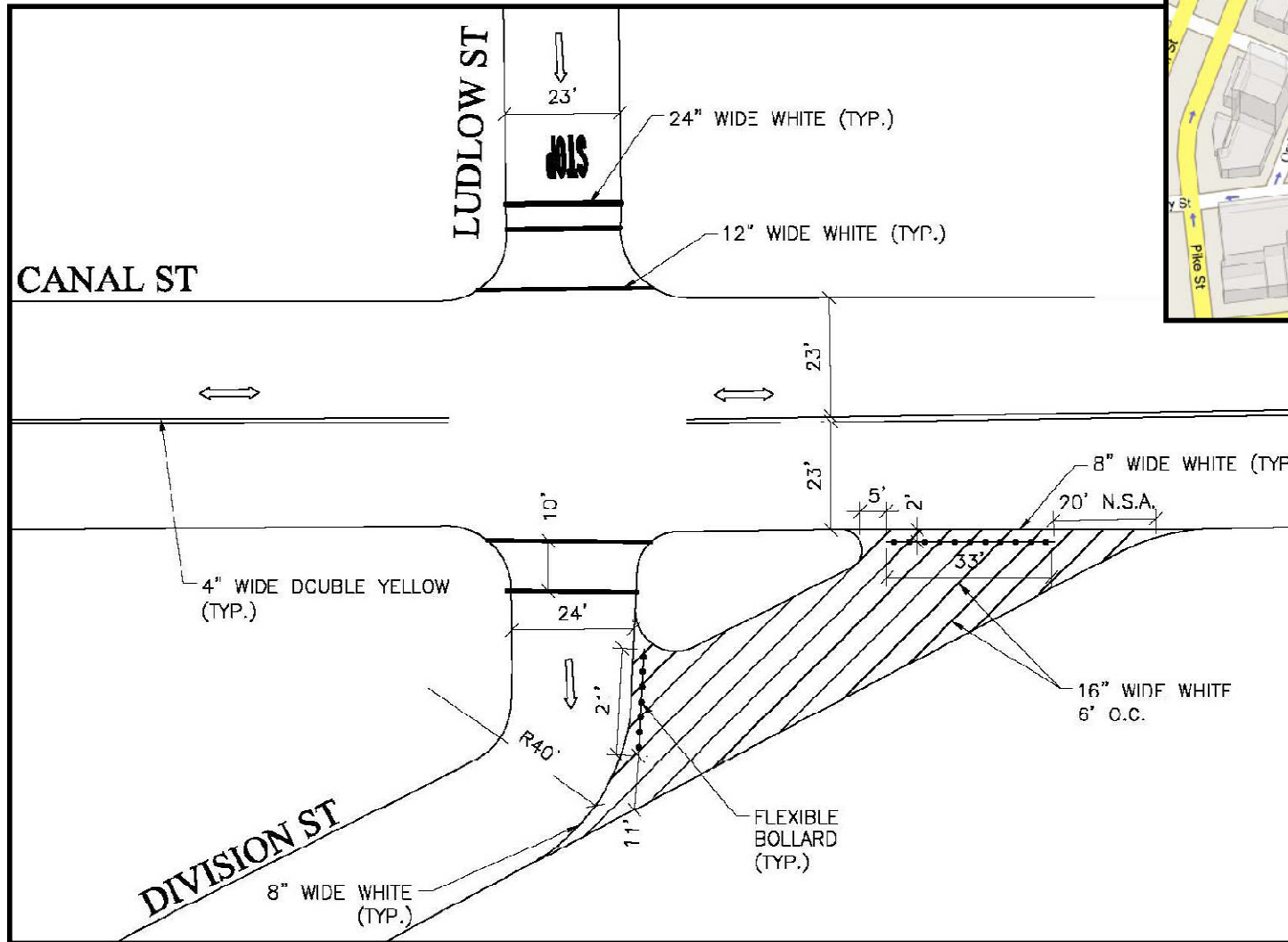

Geneva – Public Spaces and Buildings

- Increase benches in streets and parks



- Make street crossings safer and increase crossing times
- Improve footpaths and lighting

Age-friendly Geneva – Public Spaces and Buildings

- Increase benches in streets and parks
 - New benches 165
 - Benches replaced or repaired 232
- Make street crossings safer and increase crossing times
- Improve footpaths and lighting
 - Enlarged 27
 - Renovated 24
 - Other improvements 90
 - New lighting 26

Network activities

- SharePoint
- engAGE WHO
- Planned Conferences
 - Dublin
 - Singapore
- Twinning
- Best Practices
- Languages



China: 1998

MALE

FEMALE

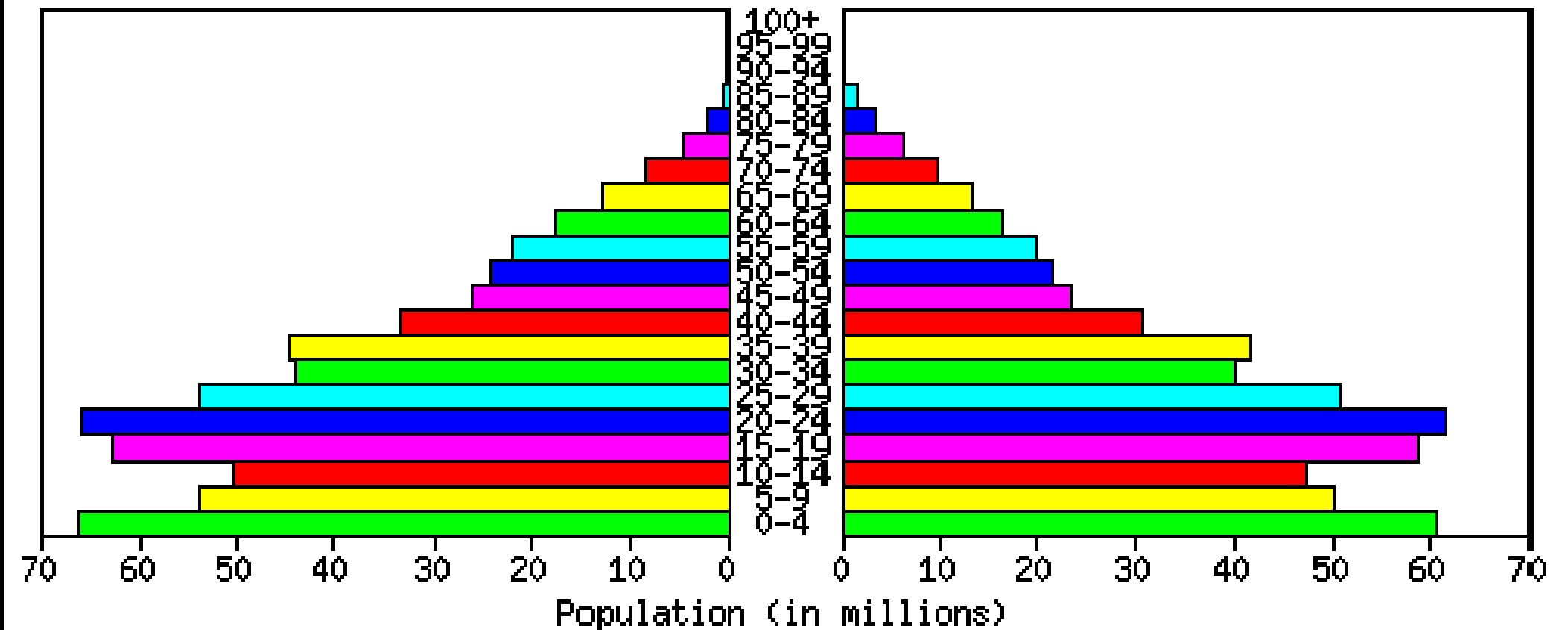

Source: U.S. Census Bureau, International Data Base.



China: 2050

MALE

FEMALE

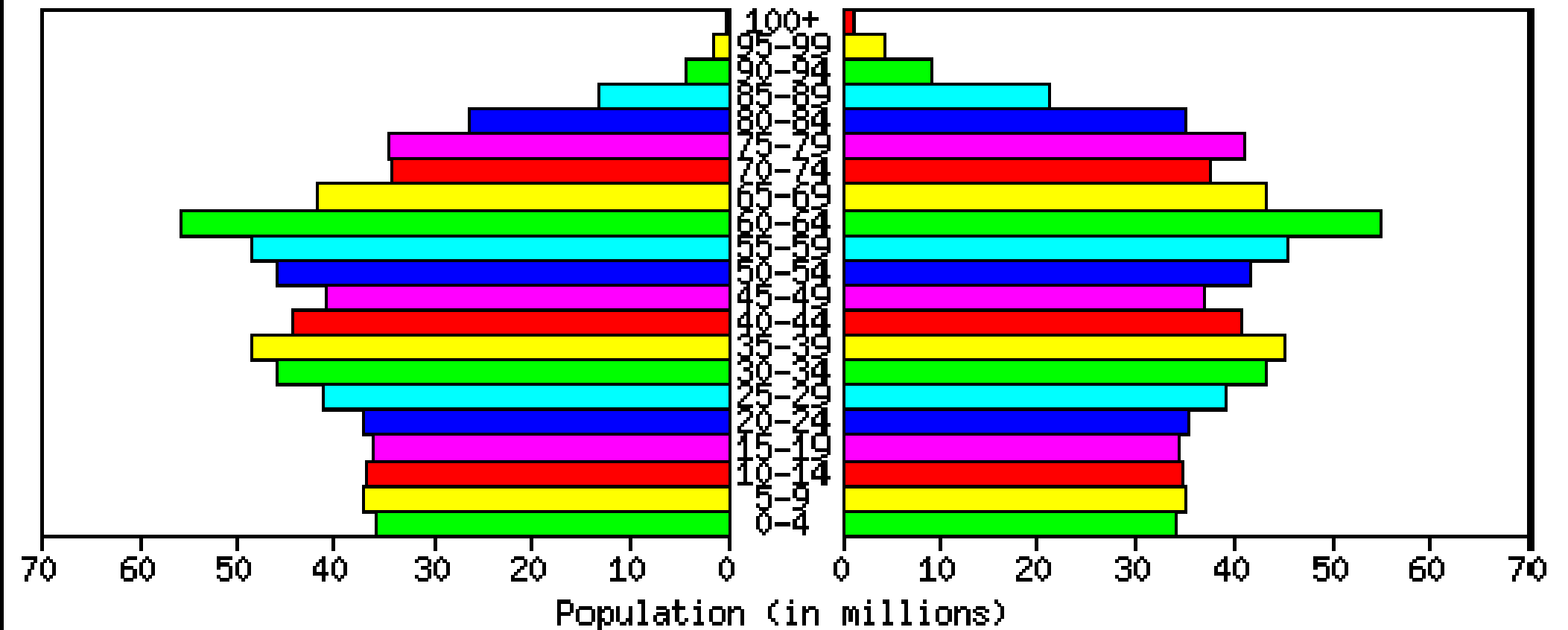

Source: U.S. Census Bureau, International Data Base.